

**Vickers®**  
**Vane Pumps**

---



## Vane Type Single Pump

**25V(M)-\*\*-A(M)(F)\*\*-22-\***

Service Data

# Vane Type Single Pump

25V(M)—\*\*A(M)(F)—\*\*-22—\*

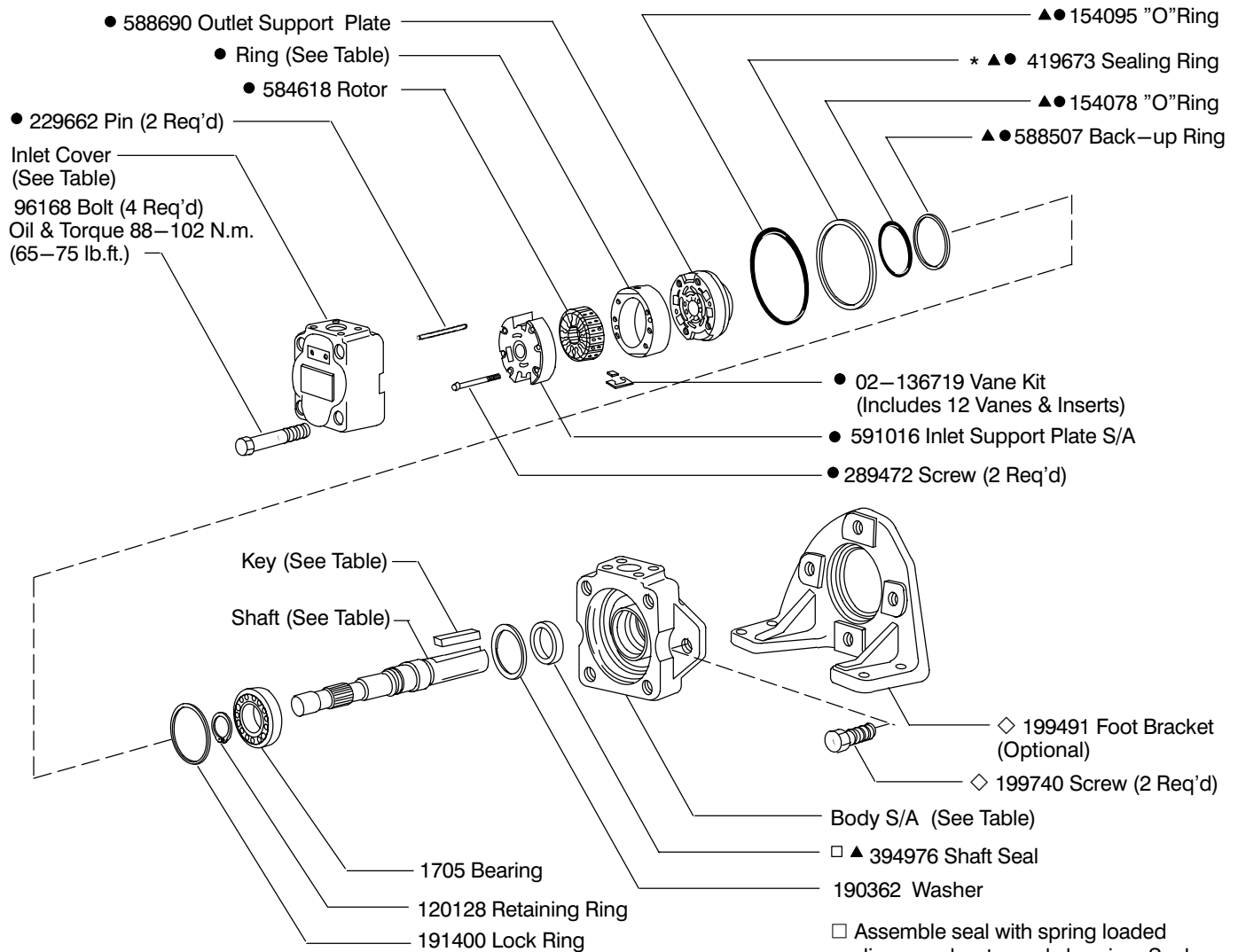

| SHAFT  | TYPE         | KEY    |
|--------|--------------|--------|
| 238755 | (1) keyed    | 9955   |
| 238929 | (11) splined | —      |
| 860076 | (192N) keyed | 472270 |

| MODEL    | INLET COVER | BODY S/A  |
|----------|-------------|-----------|
| 25V**A/C | 224309      | —         |
| 25V**B/D | 242215      | —         |
| 25V**A/D | —           | 942353    |
| 25V**B/C | —           | 942378    |
| 25VM**A  | 224309      | 02-136917 |
| 25VM**AM | 478502      | 02-136918 |

| MODEL | RING   | ● CART KIT | F3 CART KIT |
|-------|--------|------------|-------------|
| 25V12 | 584610 | 02-102532  | 02-102540   |
| 25V14 | 584612 | 02-102533  | 02-102541   |
| 25V17 | 584614 | 02-102534  | 02-102542   |
| 25V21 | 584616 | 02-102535  | 02-102543   |

- Included in cartridge kit
- ▲ Included in seal kit 922850  
F3 equivalent seal kit 919656
- ◇ Included in foot bracket kit FB-B-10
- \* Install 419673 sealing ring into body, then install cartridge kit.

# Model Code

**(F3) - 25V (M) - \*\* A (M) (F) - \* \* - 22 - \***

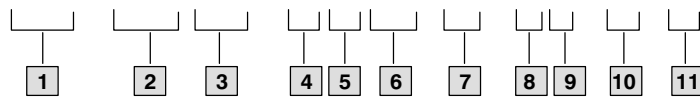

**1 Special seals**

**2 Series designation**

**25V** – 40 to 67 cm<sup>3</sup>/r  
(2.47 to 4.13 in<sup>3</sup>/r)

**3 Pilot designation**

**M** – Metric per ISO 3019/2 100A2HW  
**Omit** – Standard pilot

**4 Geometric displacement**

(Rated capacity (USgpm) at 1200 rpm, 6.9 bar (100 psi))

| Code | cm <sup>3</sup> /r | in <sup>3</sup> /r |
|------|--------------------|--------------------|
| 12   | 40                 | 2.47               |
| 14   | 45                 | 2.78               |
| 17   | 55                 | 3.39               |
| 21   | 67                 | 4.13               |

**5 Port connections**

**A** – SAE 4 bolt flange

**6 Port connection modifier**

**M** – Metric port connection (4 bolt flange)  
**Omit** – Inch thread port connection (4 bolt flange)

**7 Mounting**

**F** – Foot mounting  
**Omit** – Flange mounting

**8 Shaft**

**1** – Straight keyed  
**11** – Splined  
**192N** – Straight keyed (M pilot only)

**9 Outlet positions**

(Viewed from cover end of pump)

**A** – Opposite inlet port  
**B** – 90° CCW from inlet  
**C** – Inline with inlet  
**D** – 90° CW from inlet

**10 Design**

**11 Rotation**

(Viewed from shaft end of pump)  
**L** – Left hand for counterclockwise  
**R** – Right hand for clockwise

**NOTE**

To reverse cartridge kit rotation, remove the two screws and reverse the location of the inlet support plate and outlet support plate. Re-install the two screws hand tight. Use pump cover to align all sections of the cartridge. Carefully remove the cover and tighten the screws.

**NOTE:**

For satisfactory service life of these components in industrial applications, use full flow filtration to provide fluid which meets ISO cleanliness code 16/13 or cleaner. OFP, OFR, and OFRS series filters are recommended.

**NOTE**

When ordering spare cartridge parts, it is recommended they be obtained in cartridge kits. Kits are assembled and tested by Vickers for either right or left hand rotation. If left hand rotation is required, it should be specified on parts order by adding suffix "L" to cartridge kit number.

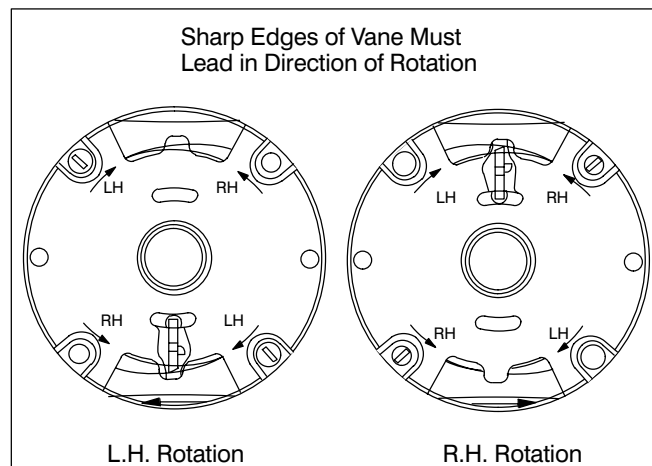

**Eaton Hydraulics**

15151 Highway 5  
Eden Prairie, MN 55344  
Telephone: 612 937-7254  
Fax: 612 937-7130  
[www.eatonhydraulics.com](http://www.eatonhydraulics.com)

46 New Lane, Havant  
Hampshire PO9 2NB  
England  
Telephone: (44) 170-548-6451  
Fax: (44) 170-548-7110

