



## **Dual Range & Adj. Max. Stop Compensator**

**PVB/E\*-(F)\*S(F)(\*)(Y)\*-C(M)D-20**

**PVB\*-(F)\*S(F)(\*)(Y)\*-C(M)DH-11**

# Dual Range & Adj. Max. Stop Compensator

PVB/E\*-(F)\*S(F)\*(Y)\*-C(M)D-20  
 PVB\*-(F)\*S(F)\*(Y)\*-C(M)DH-11

**CD, CMD, CDH, CMDH, CONTROL ADJUSTMENT PROCEDURE**

1. Loosen locknuts (1) and (4).
2. Turn adjusting spool (5) until nut (3) is bottomed against adjusting plug (2). Adjusting spool threads will be fully extended.
3. With the directional valve de-energized; or in the Hydraulic System having the pressure port 'P' blocked and port 'B' open to port 'T', adjust the lowest pressure setting by turning adjusting plug (2). Tighten locknut (1) after adjustment is completed.
4. Energize the directional valve; or in the Hydraulic System, have pressure port 'P' open to port 'A'.
5. Turn adjusting spool (5) to the highest pressure adjustment. Tighten locknut (4). This completes the adjustment procedure.

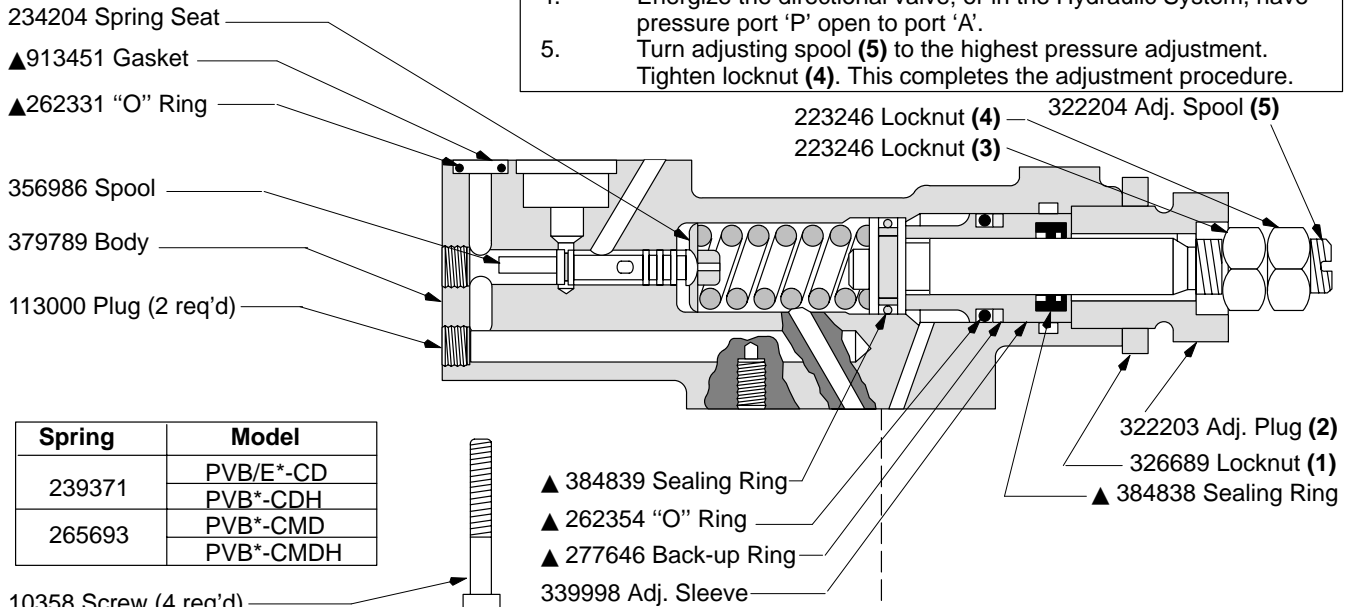

Spring	Model
239371	PVB/E*-CD PVB*-CDH
265693	PVB*-CMD PVB*-CMDH

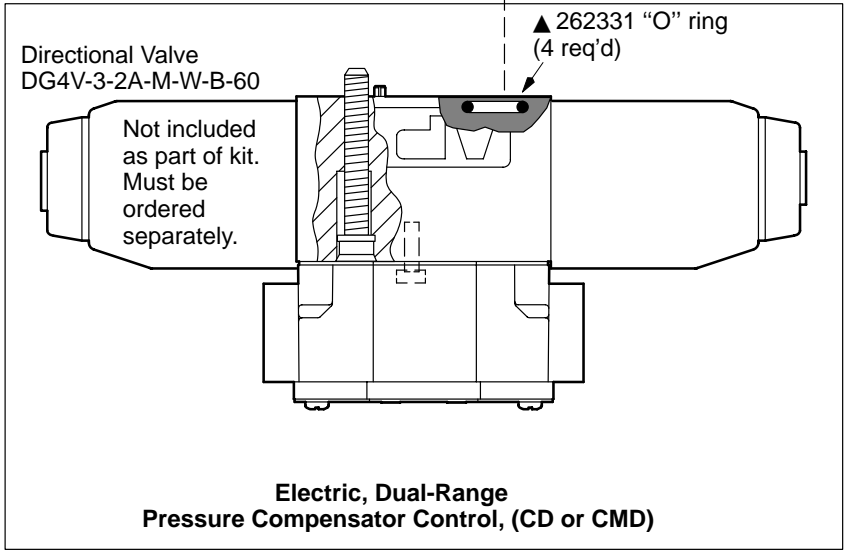
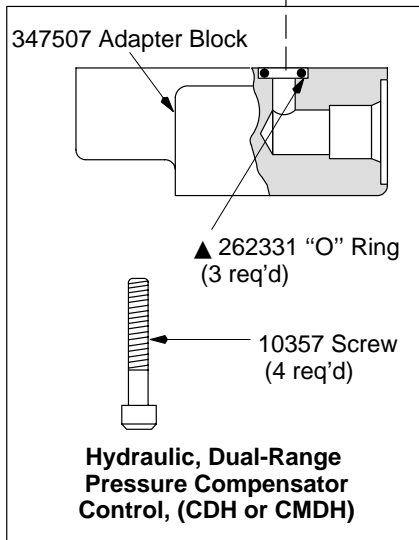

▲ Included in 919621 F3 Seal Kit

Compensator S/A kits include all parts shown except directional valve.

Compensator S/A Kit	
CMD-941033	CMDH-942114
CD-941032	CDH-942115

PVB\*-(F)\*S(F)\*(Y)\*-C(M)C-\*  
PVE19\*-Q\*\*\*\*-3\*-C\*\*-10/11

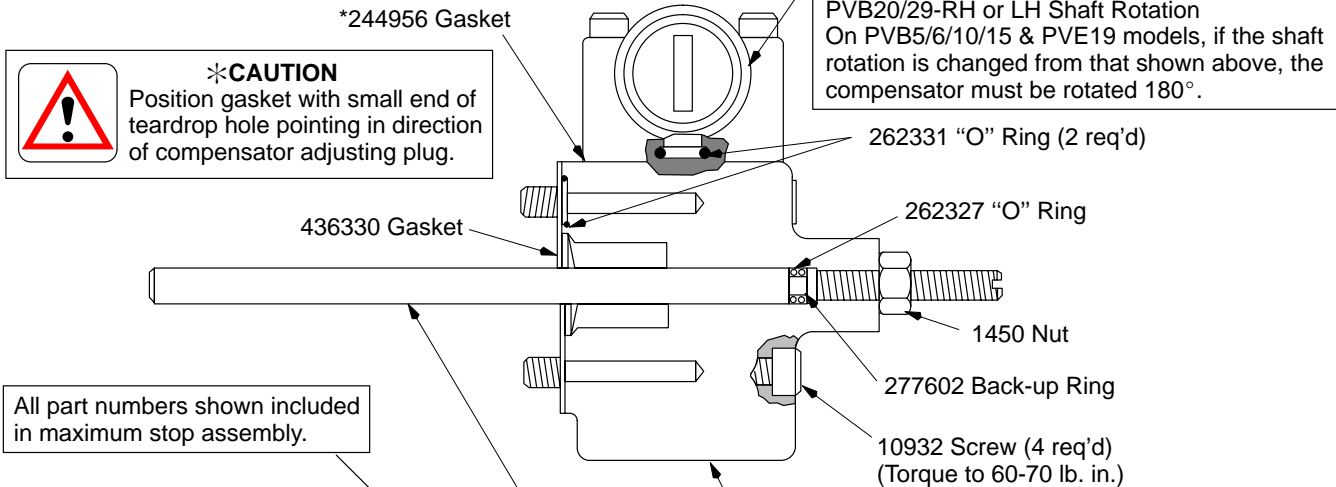

Model	Max. Stop S/A No.	Adj. Rod	Adapter Block
PVB5*-LS*-20-C(M)C-**	942188	354573	354578
PVB6*-LS*-20-C(M)C-**			
PVB5*-RS*-20-C(M)C-**	942189	354574	354579
PVB6*-RS*-20-C(M)C-**			
PVB1*-LS*-3*-C(M)C-**	942190	354575	354578
PVB1*-RS*-3*-C(M)C-**	942191		354579
PVE19L-Q****-3*-C(*)C-**	926294	354575	354578
PVE19R-Q****-3*-C(*)C-**	942192		354579
PVB2*-LS*-0-C(M)C-**			
PVB2*-RS*-0-C(M)C-**			

Included in Max. Stop S/A but not shown 200087 "O" ring, 567707 and 567848 sleeves. Sleeve 567848 (color coded red) used only on CCVP models.

To assist initial priming, manual adjustment control setting must be 40% of maximum flow position. Maximum flow position occurs when rod is fully extended.

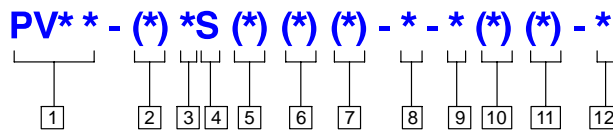

- 1 Model Series**  
Variable displacement pump, in-line design, GPM rating @1800 rpm: 5, 6, 10, 15, 19, 20, 29  
**B** - Inline B series  
**E** - Inline E series

---

- 2 Mounting**  
**F** - Foot Bracket

---

- 3 Rotation**  
**R** - Right  
**L** - Left

---

- 4 Displacement**  
**S** - Single side of center

---

- 5 Connections**  
**F** - Side port connections on 20 and 29 GPM models

---

- 6 Ports**  
**W** - Optional side ports  
(Note: (X) thru shaft models are not available with dual range comp. and max. stop features on PVB 20/29 models.

---

- 7 Standard Shaft**  
**Y** - PVB Series  
**1** - PVE Series

---

- 8 Current Pump Design**  
**5, 6, 20, 29** - 20  
**10, 15, 19** -30

---

- 9 Compensator Spring**  
(Refer to specific pump drawing for compensator pressure range.)

---

- 10 Stop**  
**C** - Adjustable max. stop.

---

- 11 Compensator**  
**D** - Dual electric  
**DH** - Dual Hydraulic

---

- 12 Design**

For satisfactory service life of these components, use full flow filtration to provide fluid which meets ISO cleanliness code 16/13 or cleaner. Selections from OFP, OFR and OFRS filter series are recommended.