

**Vickers®**  
**Vane Pumps**

---



**Single Vane Type**  
**V330–S214**

# Service Data

## Single Vane Pump

V330-S214

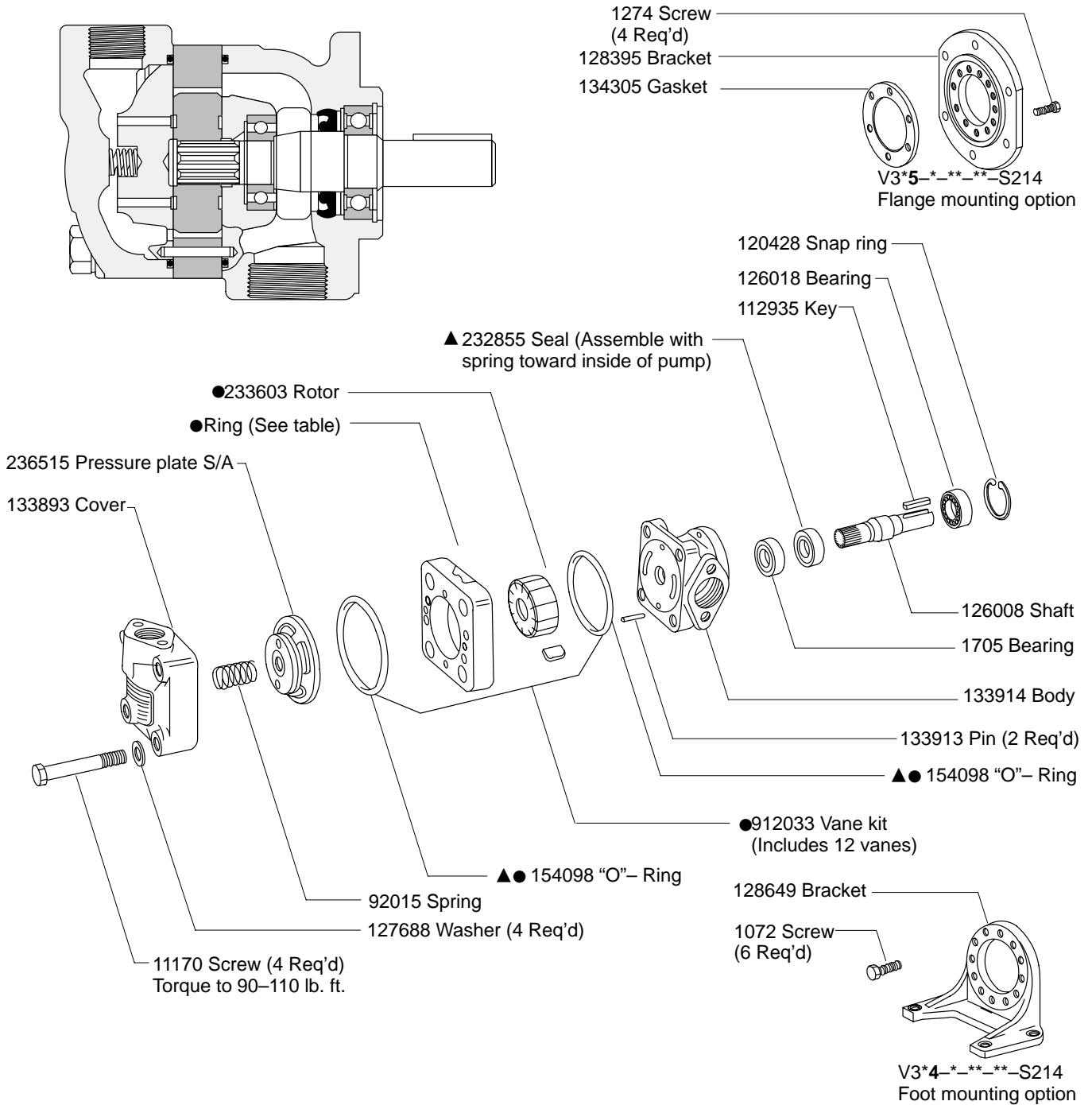

Capacity	● Ring	● Cart. kit
V33*-15-1C-S214	126023	919146
V33*-19-1C-S214	126024	919147
V33*-24-1C-S214	126025	919148

- ▲ Included in seal kit 922770  
F3 Equivalent seal kit 919292
- Included in Cartridge kit

# Model Code

**V 3 3 \* - \*\* - 1 \* - 11 -S214**

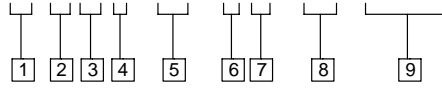

**1 Vane pump**

**5 Capacity in G.P.M.**

**8 Design and modifications**

**2 Series**

**6 Shaft**

**9 Special feature**

**3 Body type**

**3 – Face mounting**

**7 Cover port position**  
(Viewed from cover end)

- A – 180° from inlet port**
- B – 90° CCW from inlet port**
- C – Inline with inlet port**
- D – 90° CW from inlet port**

**4 Mounting**

- 0 – Body**
- 4 – Foot**
- 5 – Flange**

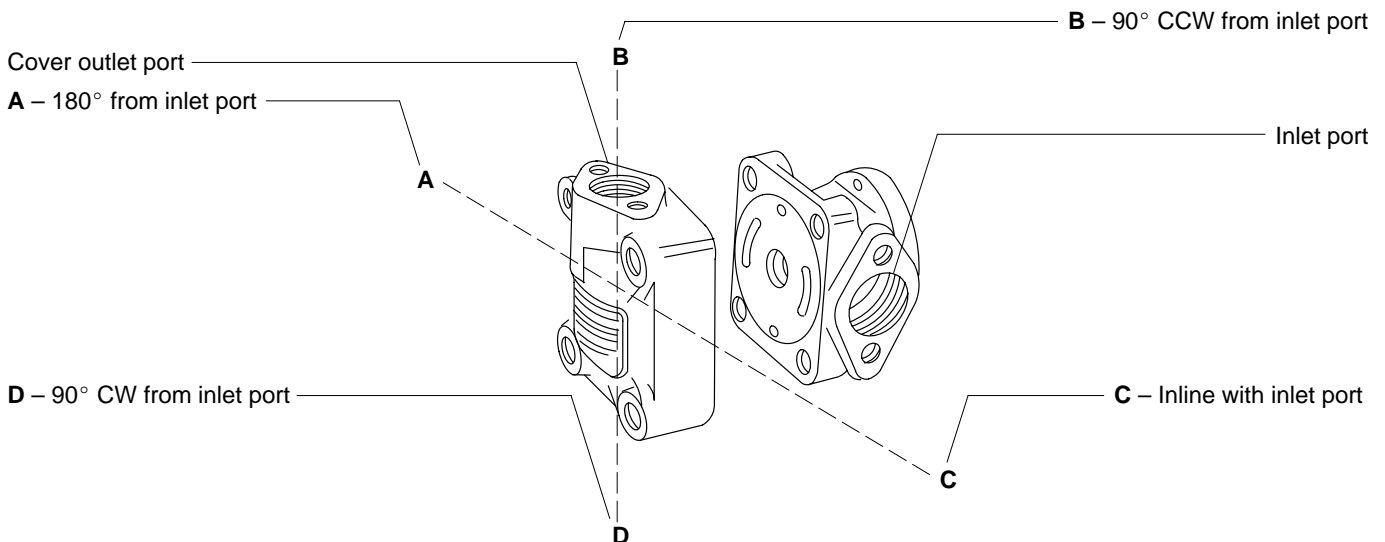

**Eaton Hydraulics**

15151 Highway 5  
Eden Prairie, MN 55344  
Telephone: 612 937-7254  
Fax: 612 937-7130  
[www.eatonhydraulics.com](http://www.eatonhydraulics.com)

46 New Lane, Havant  
Hampshire PO9 2NB  
England  
Telephone: (44) 170-548-6451  
Fax: (44) 170-548-7110

